

ProtoGENI

Robert Ricci

3rd GEC

HP, Palo Alto, California

October 28, 2008

4 Things

4 Things

- ▶ Control Framework

4 Things

- ▶ Control Framework
- ▶ Nationwide Backbone

4 Things

- ▶ Control Framework
- ▶ Nationwide Backbone
- ▶ Diverse Components

4 Things

- ▶ Control Framework
- ▶ Nationwide Backbone
- ▶ Diverse Components
- ▶ Integrated Projects

Control Framework

Control Framework Pieces

- ▶ Clearinghouse
- ▶ Security Model
- ▶ Aggregate Component Manager(s)
- ▶ Operations & Management
- ▶ Data Structures and Wire Formats

Building on...

- ▶ Emulab:
 - ▶ Component / link management
 - ▶ Resource allocation
 - ▶ User management
- ▶ PlanetLab and VINI: PC slicing

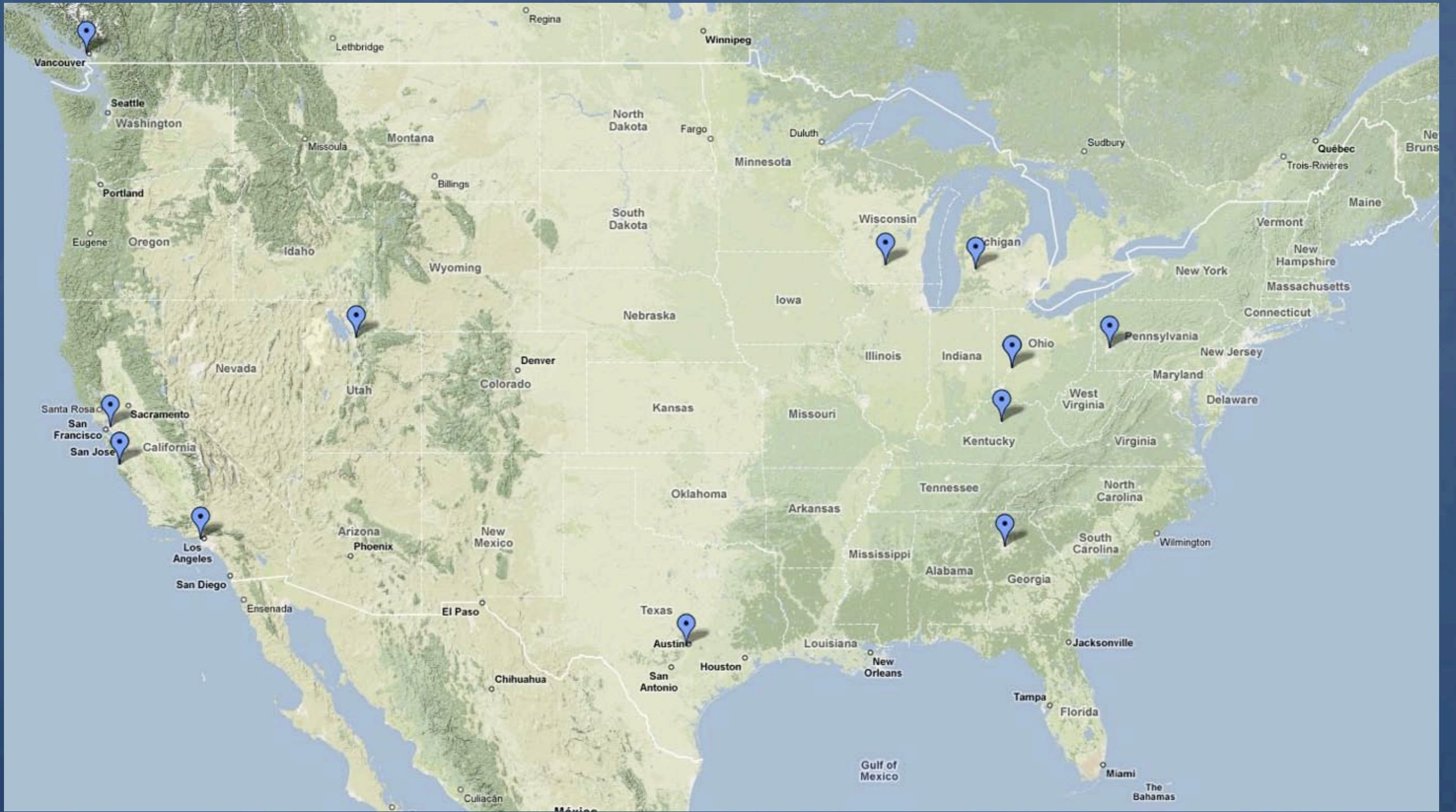

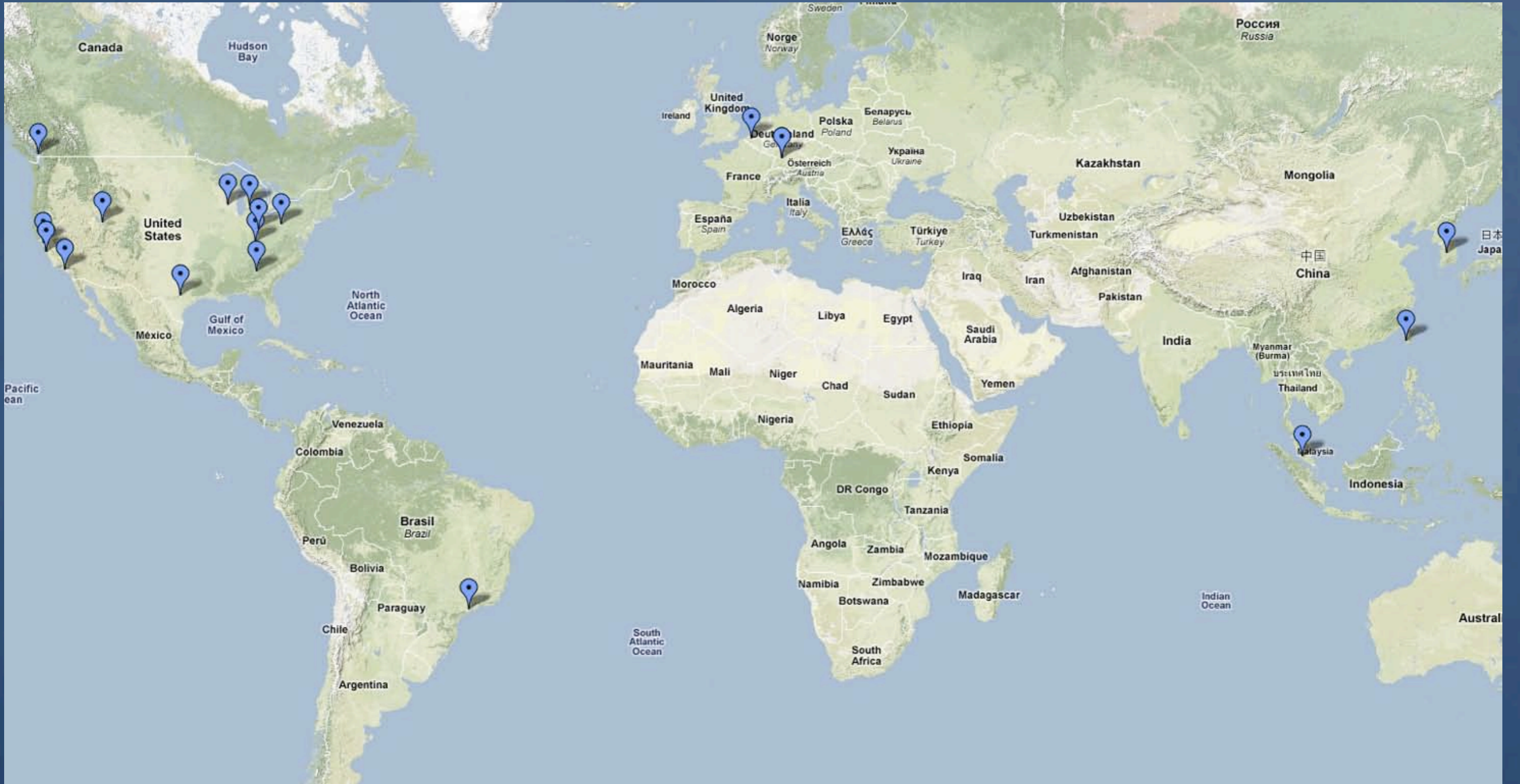

Backbone

INTERNET[®]



INTERNET[®]

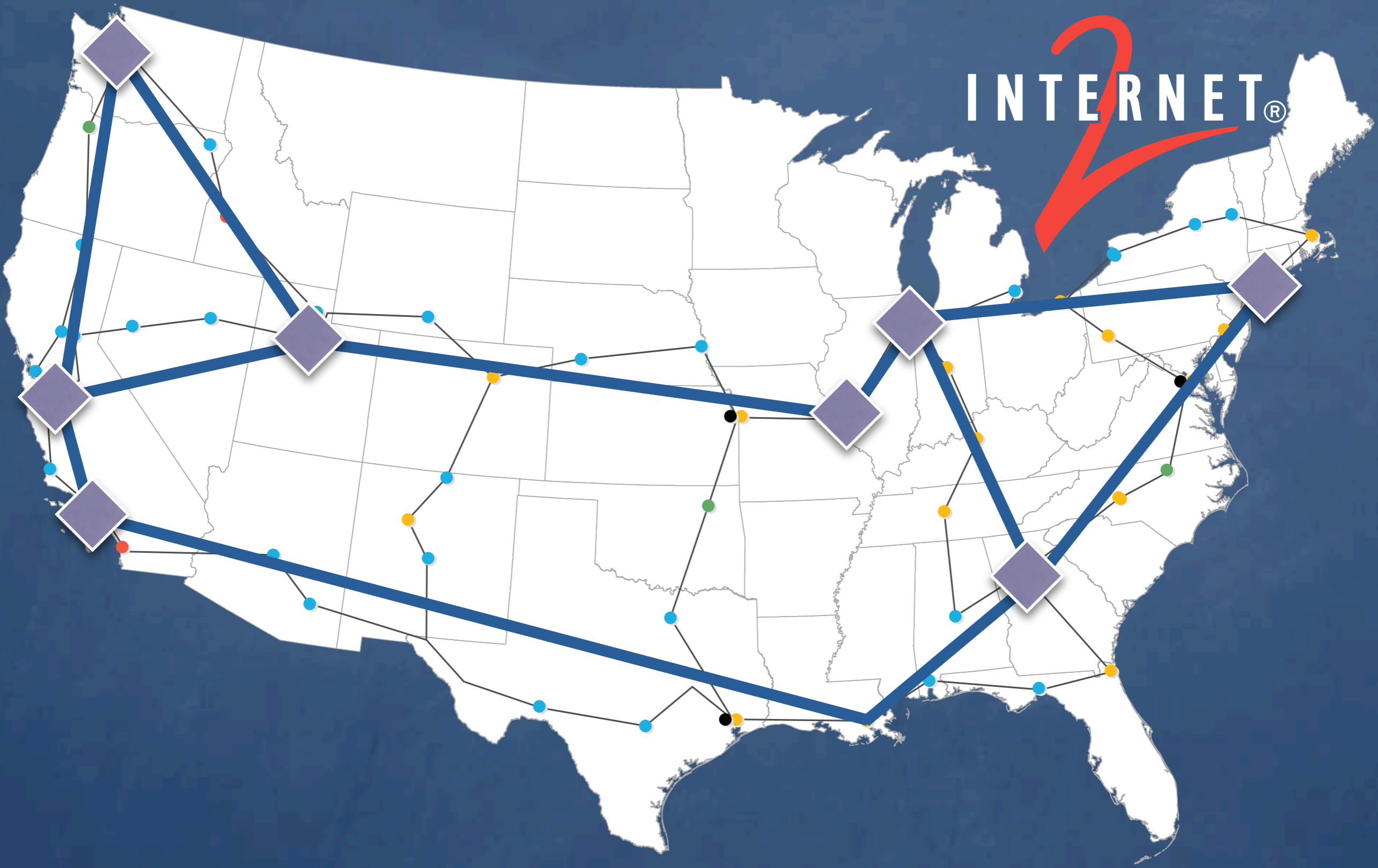

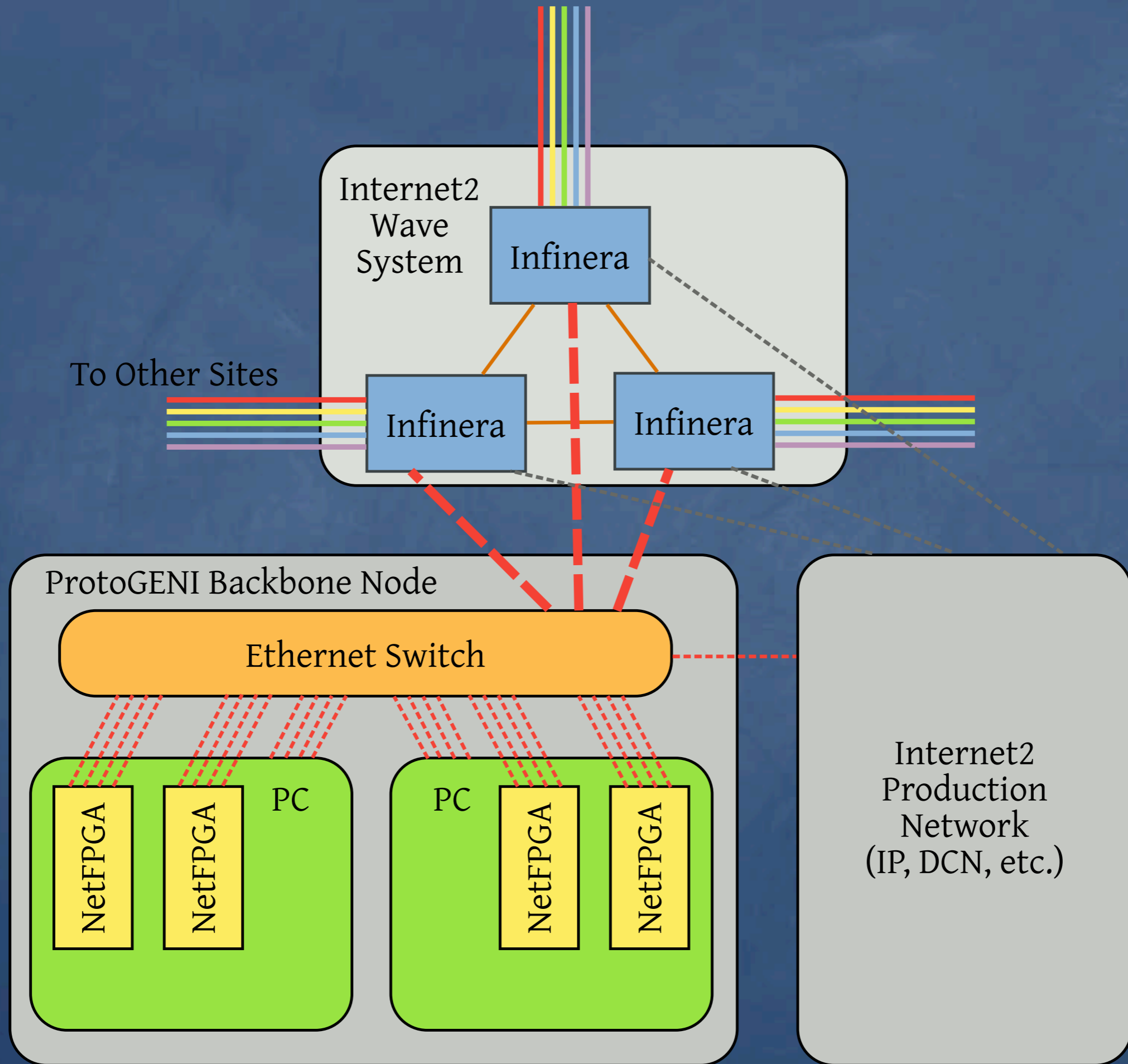

Components



hp procure
switch 2324
J4818A



Power

Download port

Fault



flickr user "Fred3d.org"



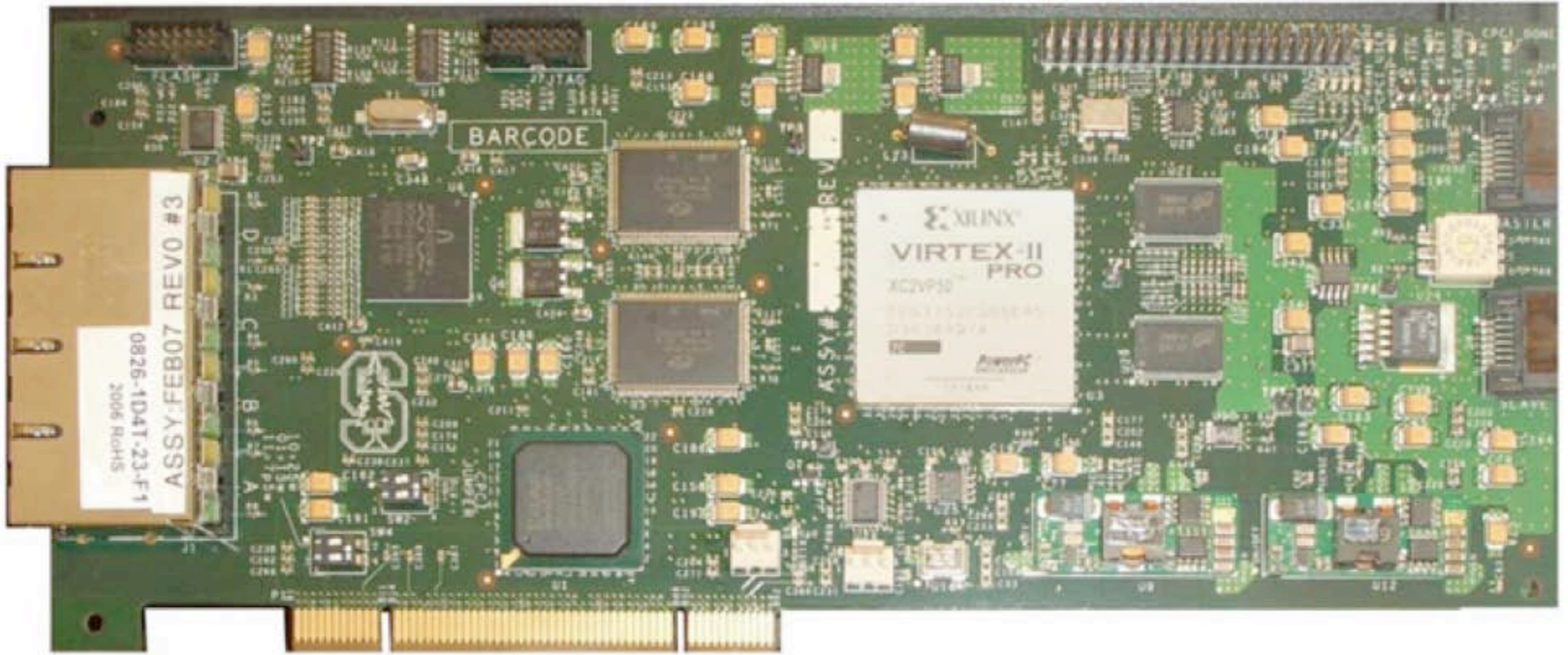

0826-1D4T-23-F1
ASSY:FEB07 REV0 #3
2006 RoHS

BARCODE

XILINX
VIRTEX-II
PRO
XC2VP50
XILINX CORPORATION
100 TAYLOR STREET
SAN JOSE, CA 95128
www.xilinx.com

ASSY # REV #

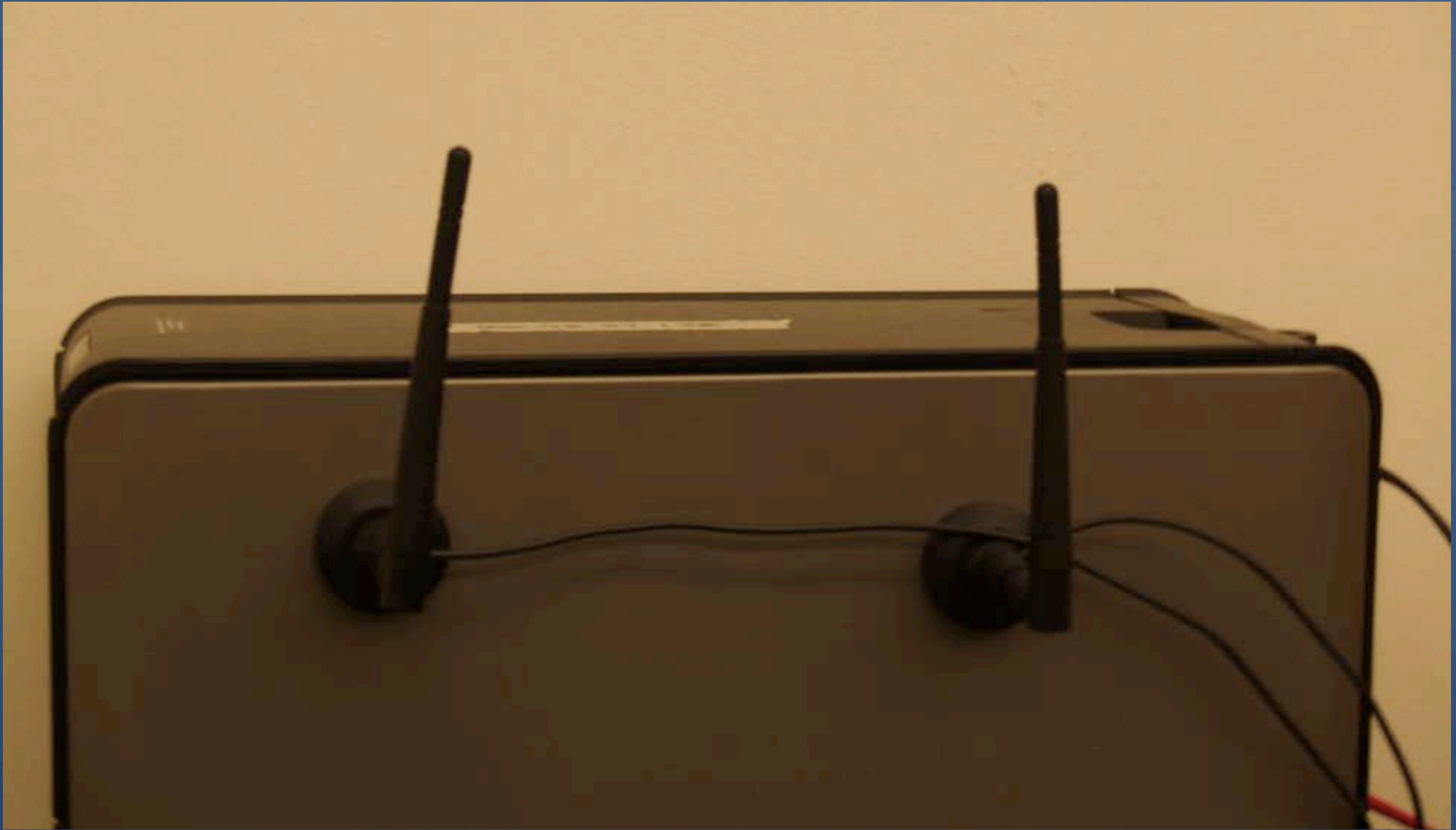

Merrill Engineering Building - 3rd floor

10 Meters

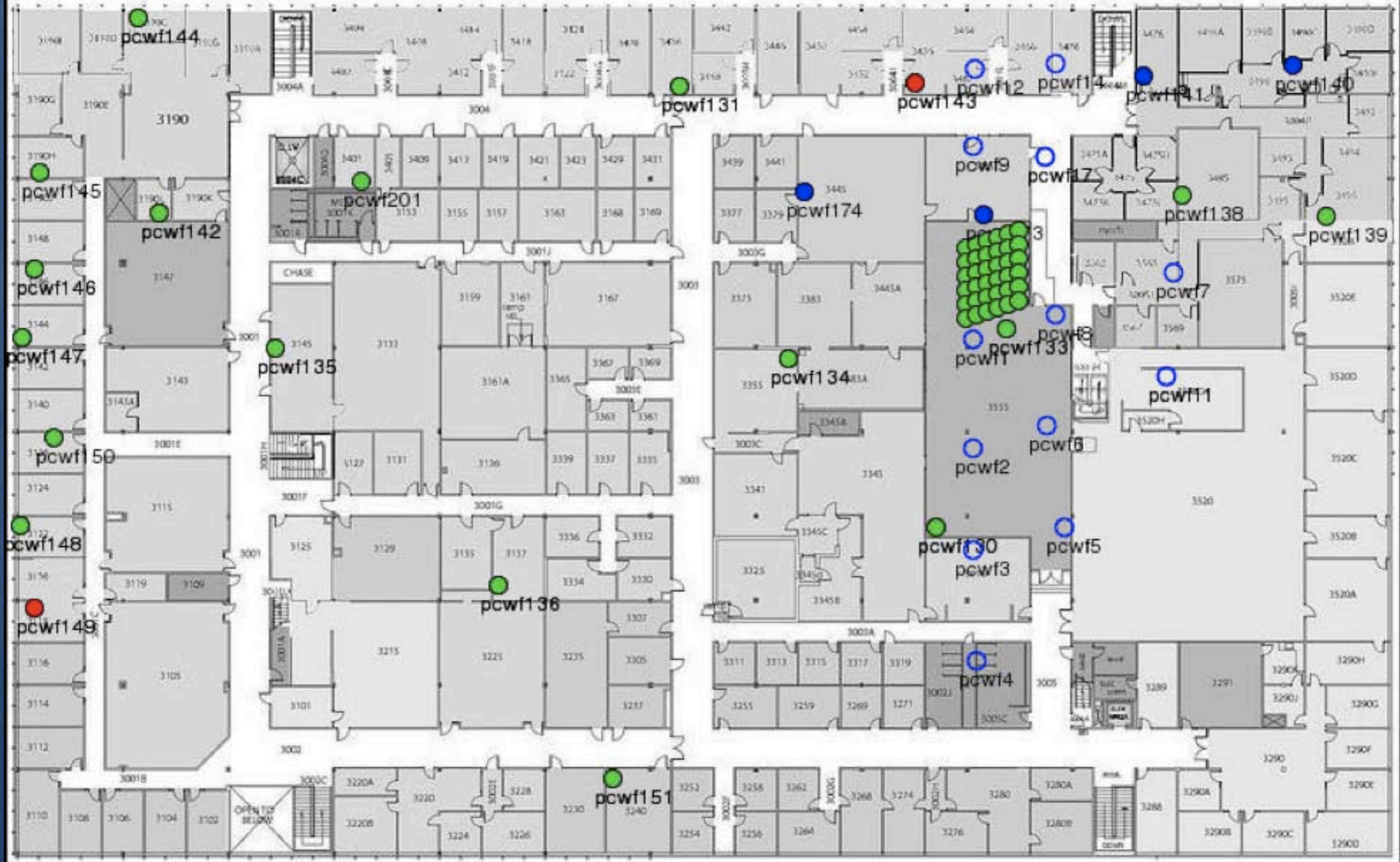

Ettus Research

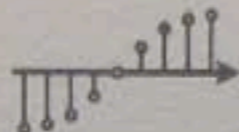

USRP2



RF1



RF2

REF
CLOCK



PPS
IN



SD MEMORY



MIMO EXPANSION



GB ETHERNET



A ● B ●
C ● D ●
E ● F ●

POWER
6V DC 3A



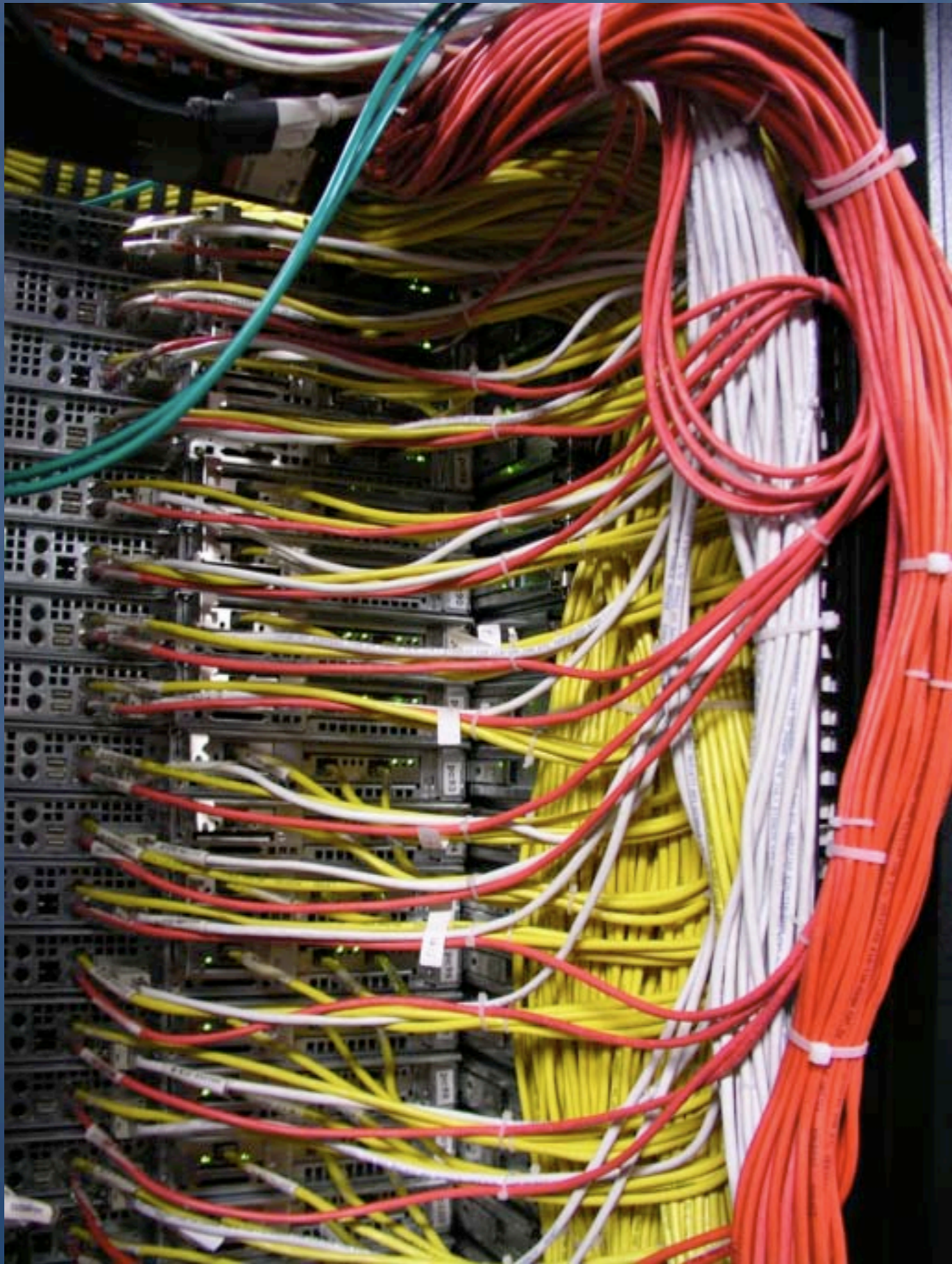

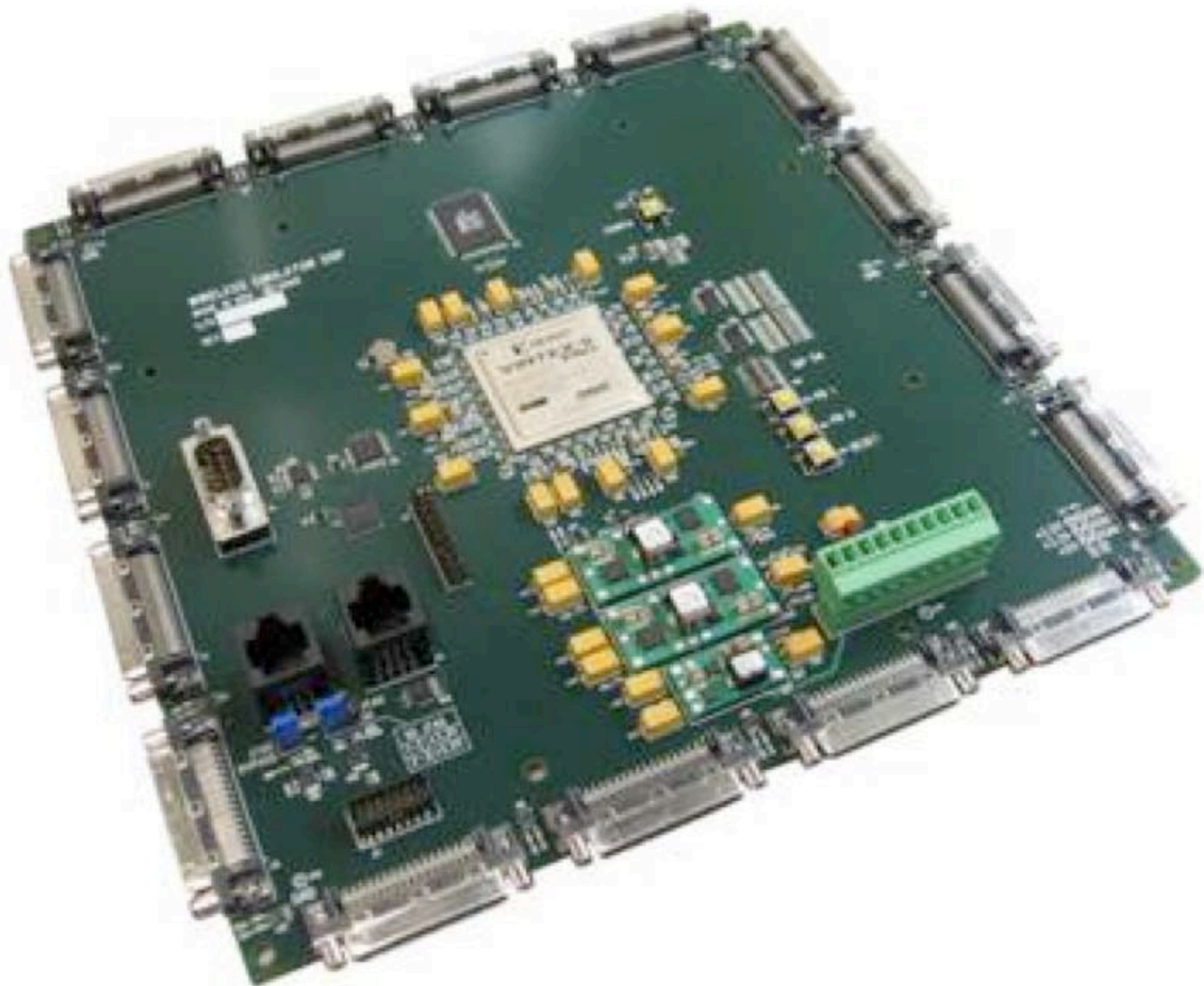

Integration

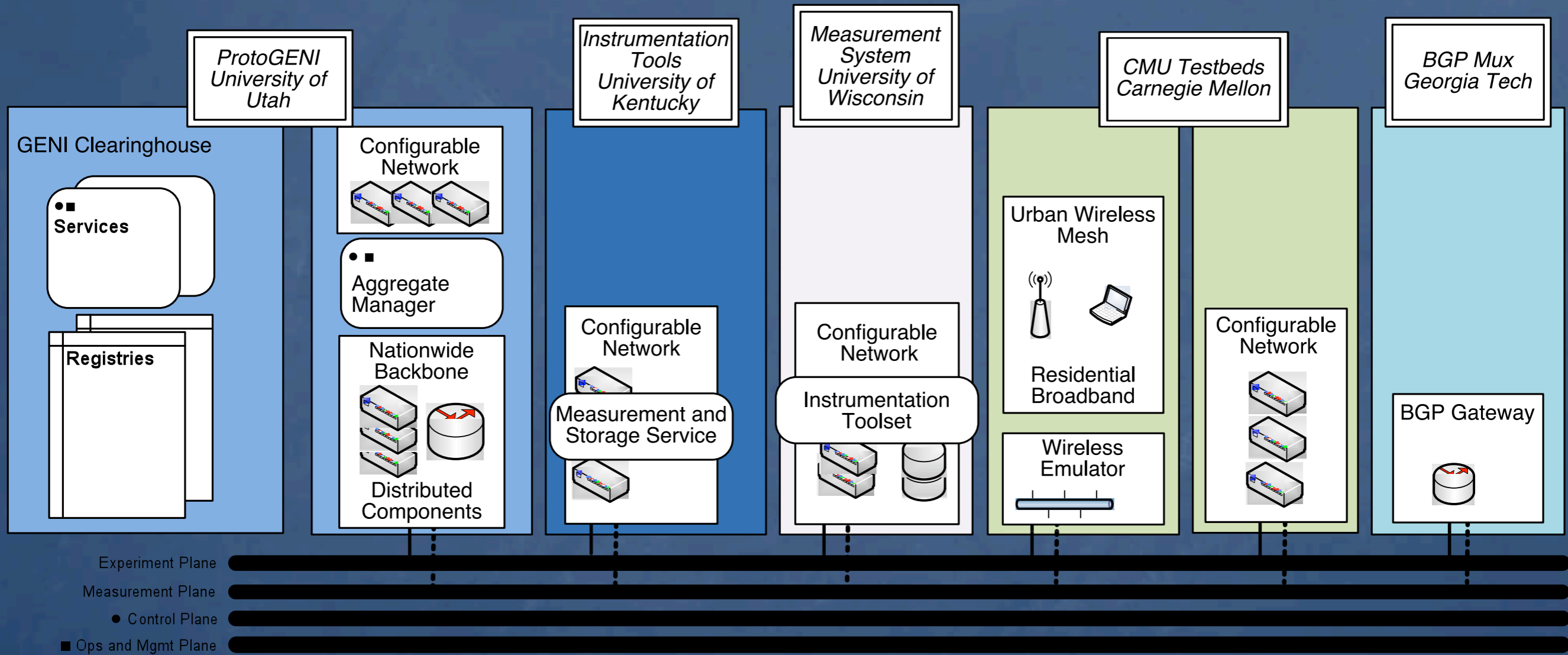

ProtoGENI Partners

- ▶ Internet2: Backbone links and hosting space
- ▶ HP: Switches and Programmable Edge Cluster

Cluster Projects

- ▶ Instrumentation Tools (Kentucky)
- ▶ Measurement System (Wisconsin)
- ▶ Virtual Tunnels and BGP Mux (Georgia Tech)
- ▶ HomeNet and Wireless Emulator (CMU)
- ▶ Security Architecture (Sparta)

6-12 Months

Now + 6-12 months (1)

- ▶ Clearinghouse running + more functionality
- ▶ Two aggregate managers running + partner sites running AMs and connected to our clearinghouse
- ▶ Exclusive and shared components + better sliced components through VINI kernel

Now + 6-12 months (2)

- ▶ First backbone sites deployed
- ▶ Extensive VLAN support + VLANS across country (including shared components)
- ▶ A few edge sites + more edge sites

Now + 6-12 months (3)

- ▶ Tunnels on exclusive components + tunnels on shared components
- ▶ Embedding service for Emulab + embedding service for ProtoGENI
- ▶ Basic RSpec + more advanced RSPEC
- ▶ Basic credentials + more advanced credentials

www.protogeni.net